



SHENZHEN CENTURY SUNSHINE LIGHTING LIMITED



# AI SERIES

Specification

# LUXMAN



## Product Details

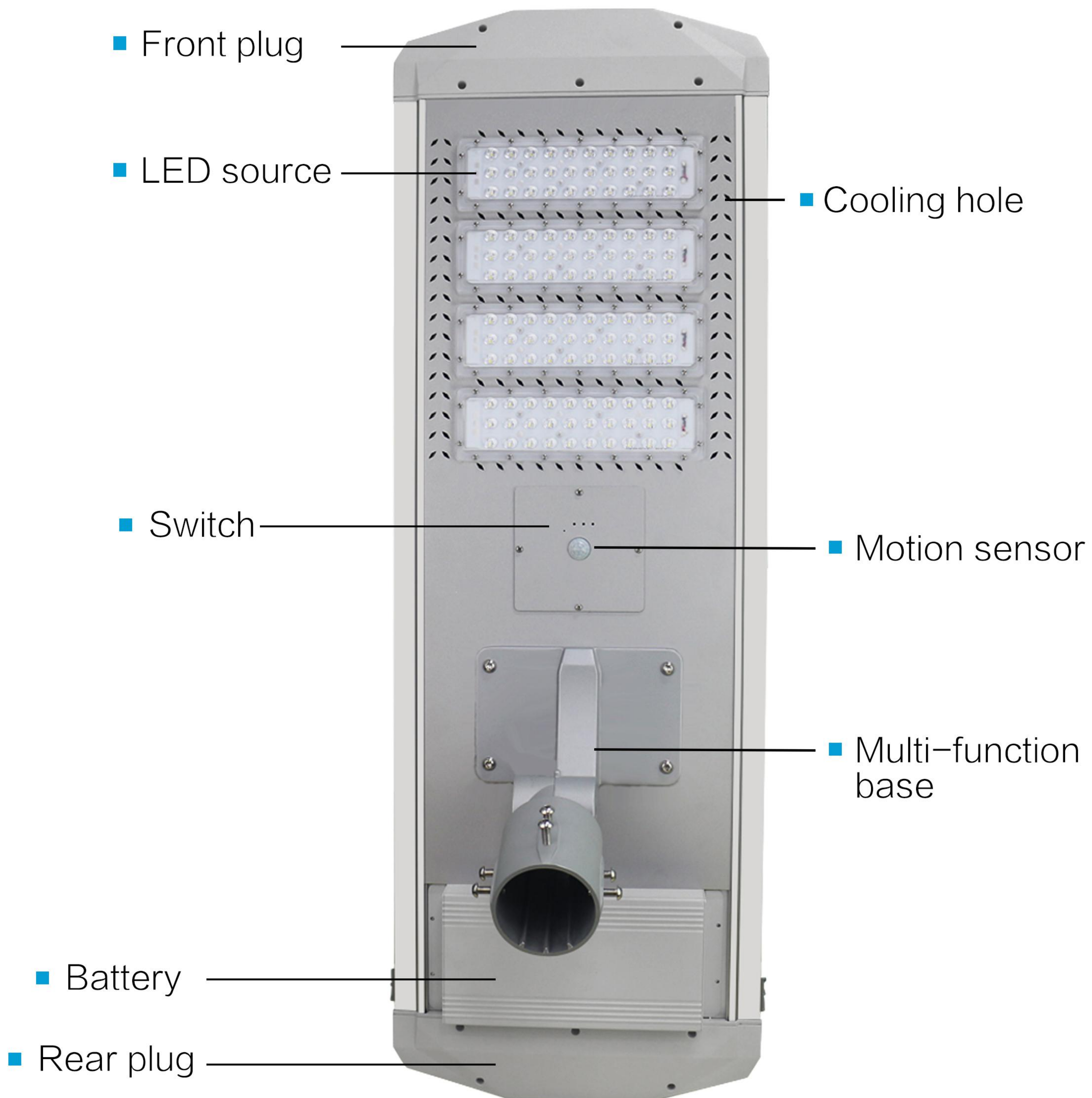



## Product Feature



The angle can rotate with the sun, and easy maintenance of battery status



MPPT controller  
The charging efficiency is more than 30% higher than that of conventional PWM



High quality LED  
Super bright special lamp beads



Strong absorption of solar panels;  
Adjust the angle up to 75 degrees



Mould plug  
Smooth appearance and structure;The overall appearance is beautiful



It was adjusted 24 times during the day;The power consumption is 0.05wh/day



## PRODUCT INSTRUCTIONS



13 key remote control

### Mode setting:

The mode setting are: time control mode, sensing mode and mixed mode

### Duration setting:

Set the duration of lighting, including 12 hours, 9 hours and 6 hours respectively

### Brightness setting:

Set the brightness of the light source, with 100% brightness, 70% brightness and 50% brightness respectively

## PRODUCT ADVANTAGES

- Easily set the working mode of solar street light;
- 10–12m infrared sensing range of remote control, suitable for most installation height
- Multiple working modes to deal with various complex environments
- According to the demand, the running time can be reasonably controlled, and it can last for a long time in the rainy days.

T—— (Time control mode ); I—— ( Sensor control mode );  
 TI: ( Mixed control mode, time control in the first 5 hours; sensor control in the last 7 years)



## Induction range

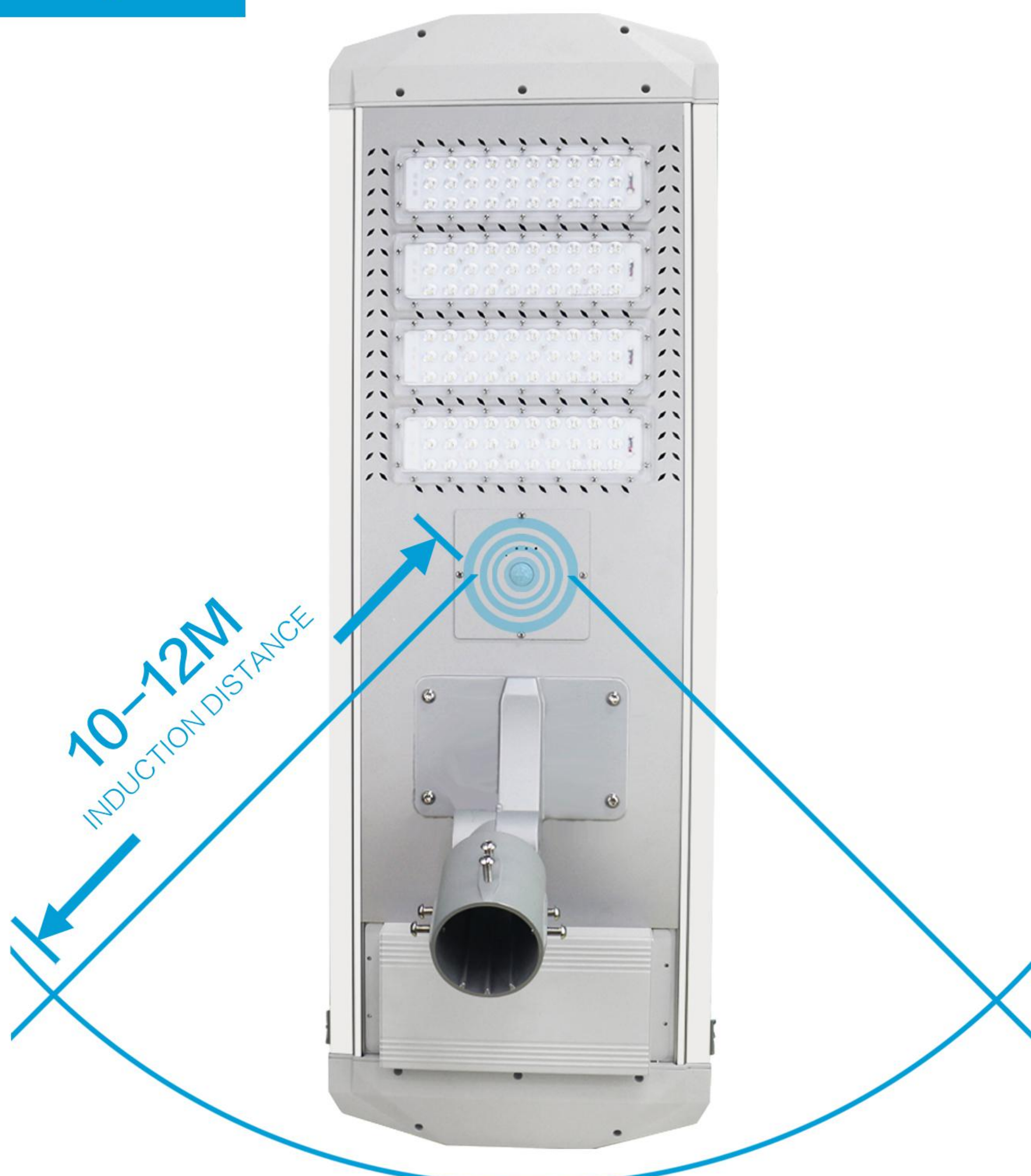

## Induction effect

120°  
INDUCTION ANGLE





## INTRODUCTION TO MATERIALS USEF

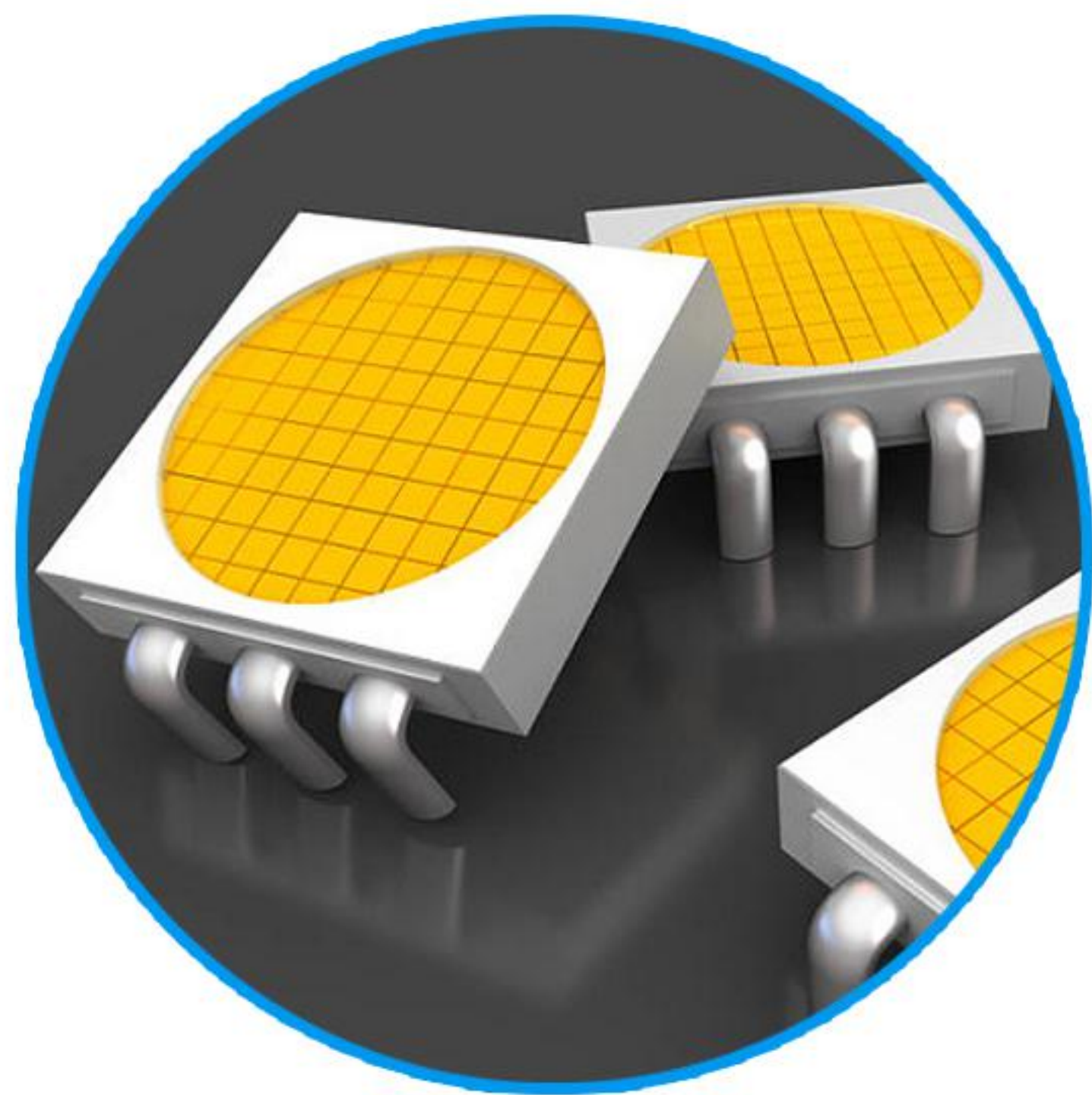

### LED ENERGY-SAVING LIGHT SOURCE

Adopt imported high light bulb beads Ultra high photosynthetic efficiency Persistent lighting

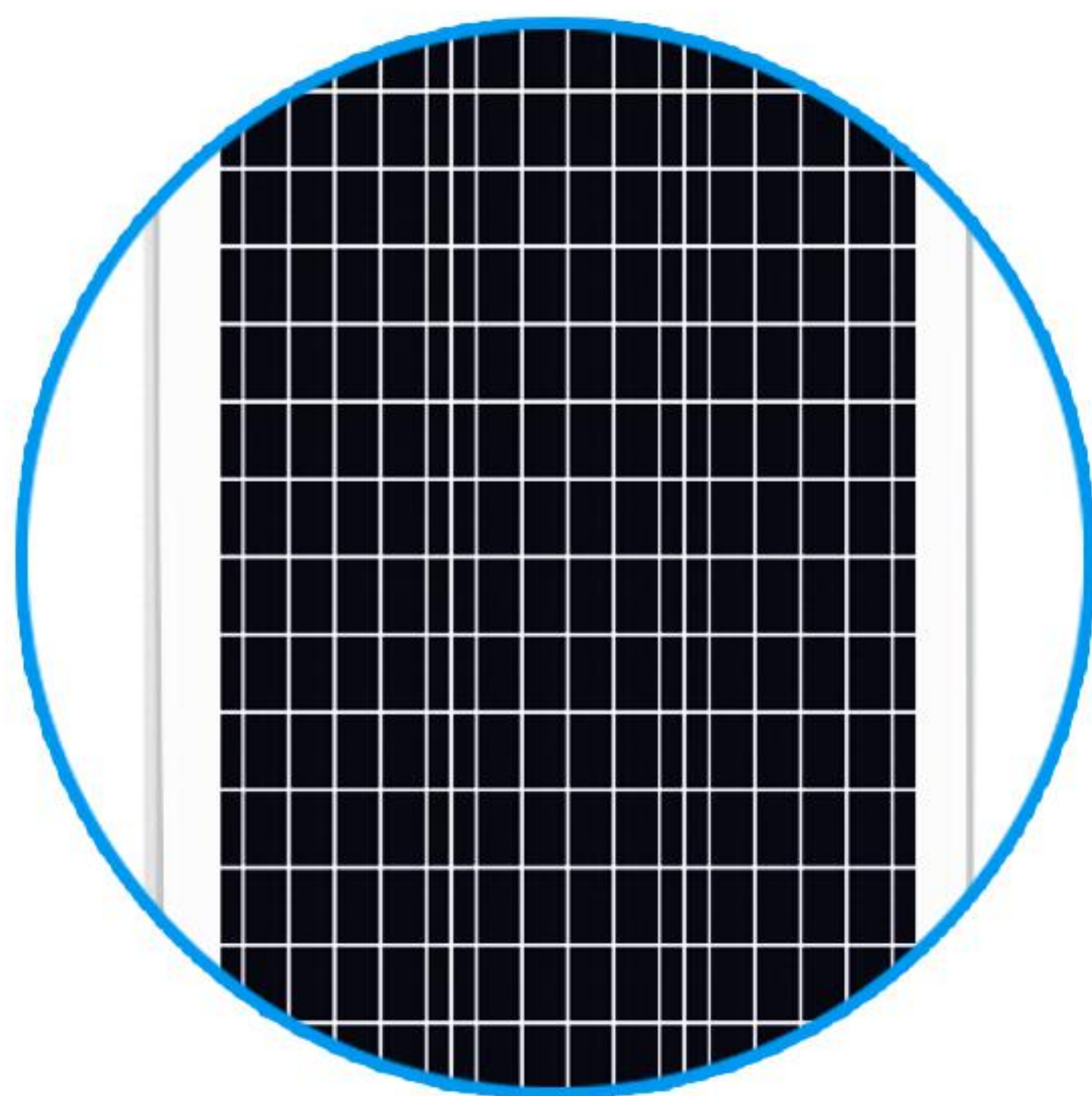

### THE SOLAR PANELS

Efficiently imported silicon high efficiency Special surface treatment

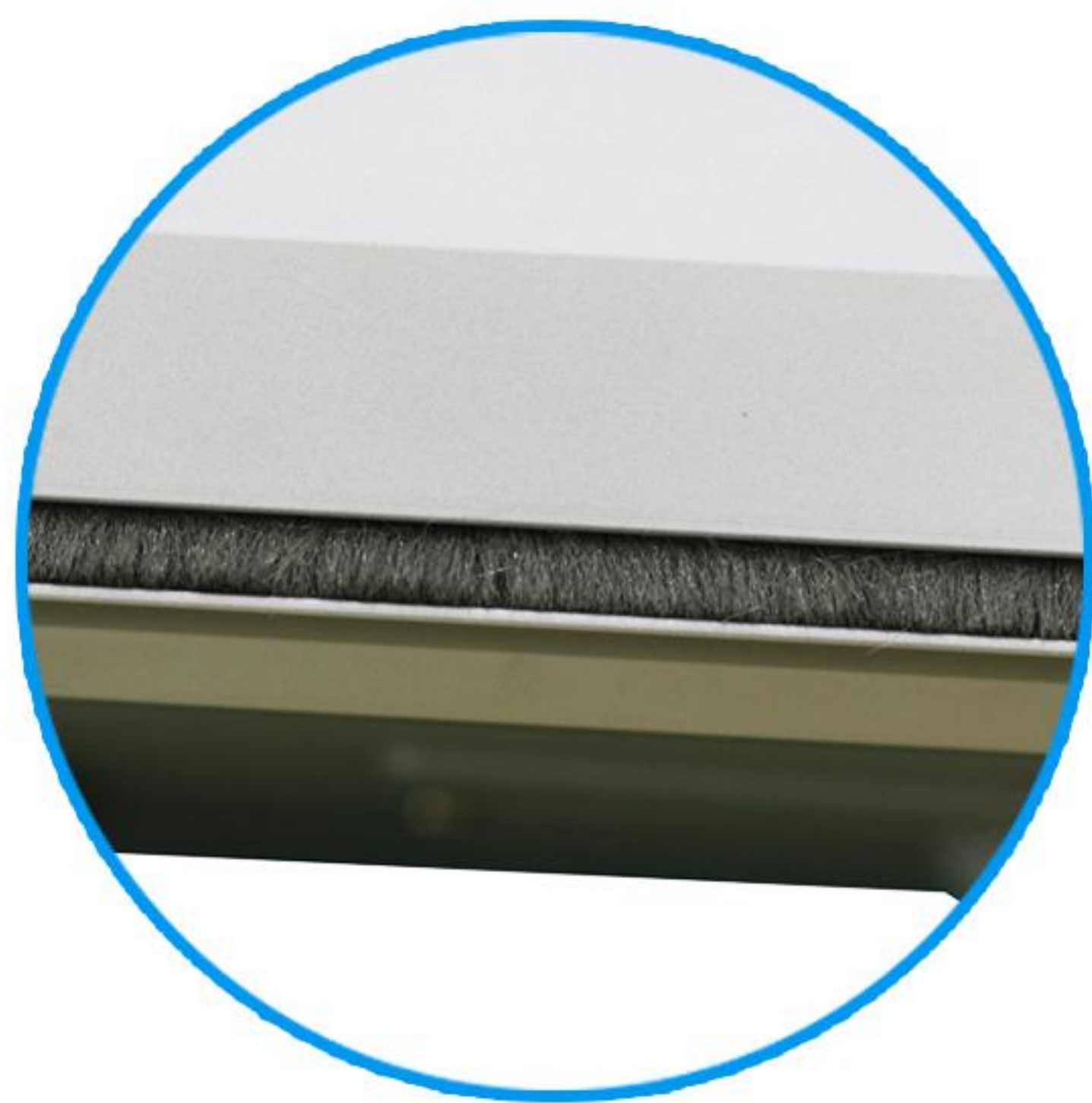

### CLEAN

Can clean the surface of the solar panel, there will be no dust, leaves on it, affect the power generation

## INTRODUCTION TO MATERIALS USEF



Integrated to all in one, easy installation and maintenance.



Multiple controlling mode, easy operation.



Imported lamp beads, long lifespan



Customizing battery box, waterproof, high and low temperature resistance



Imported solar panels, ultra high conversion rate



Multiple sensor modes, intelligent controlling lighting mode.



## Product Size

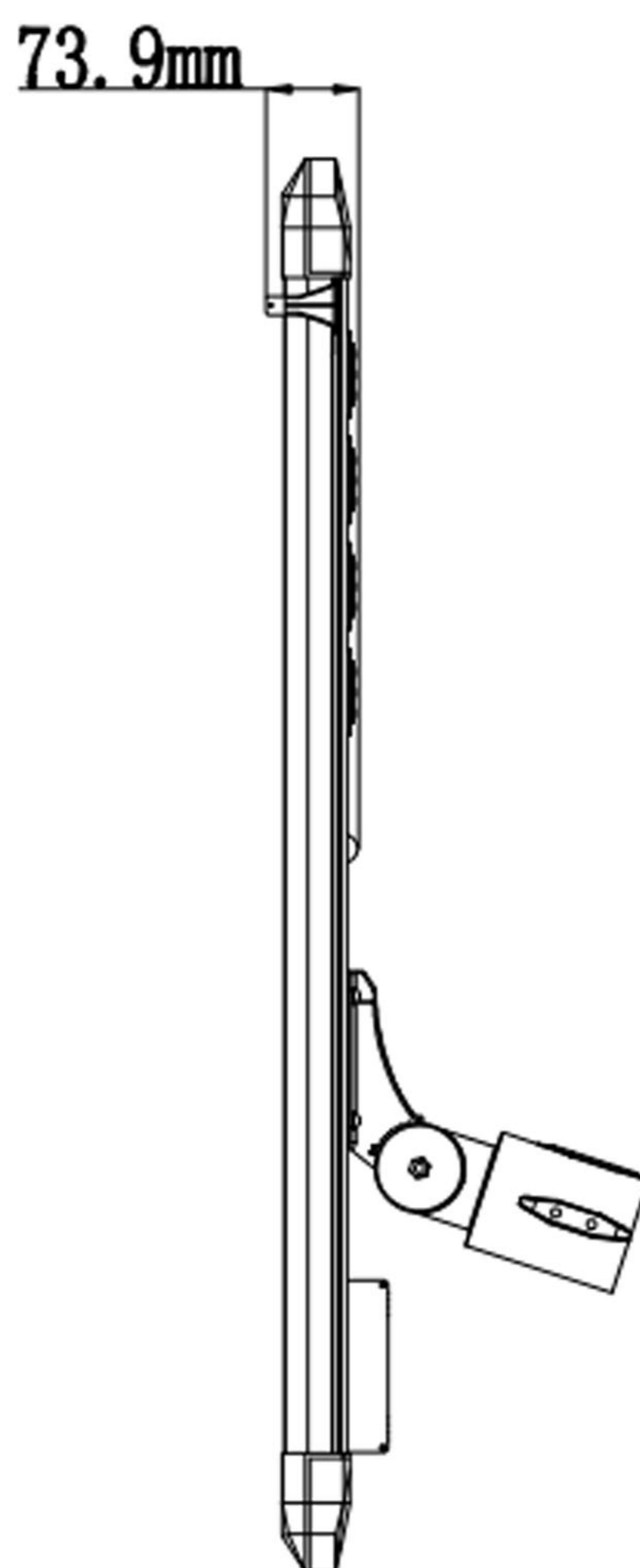
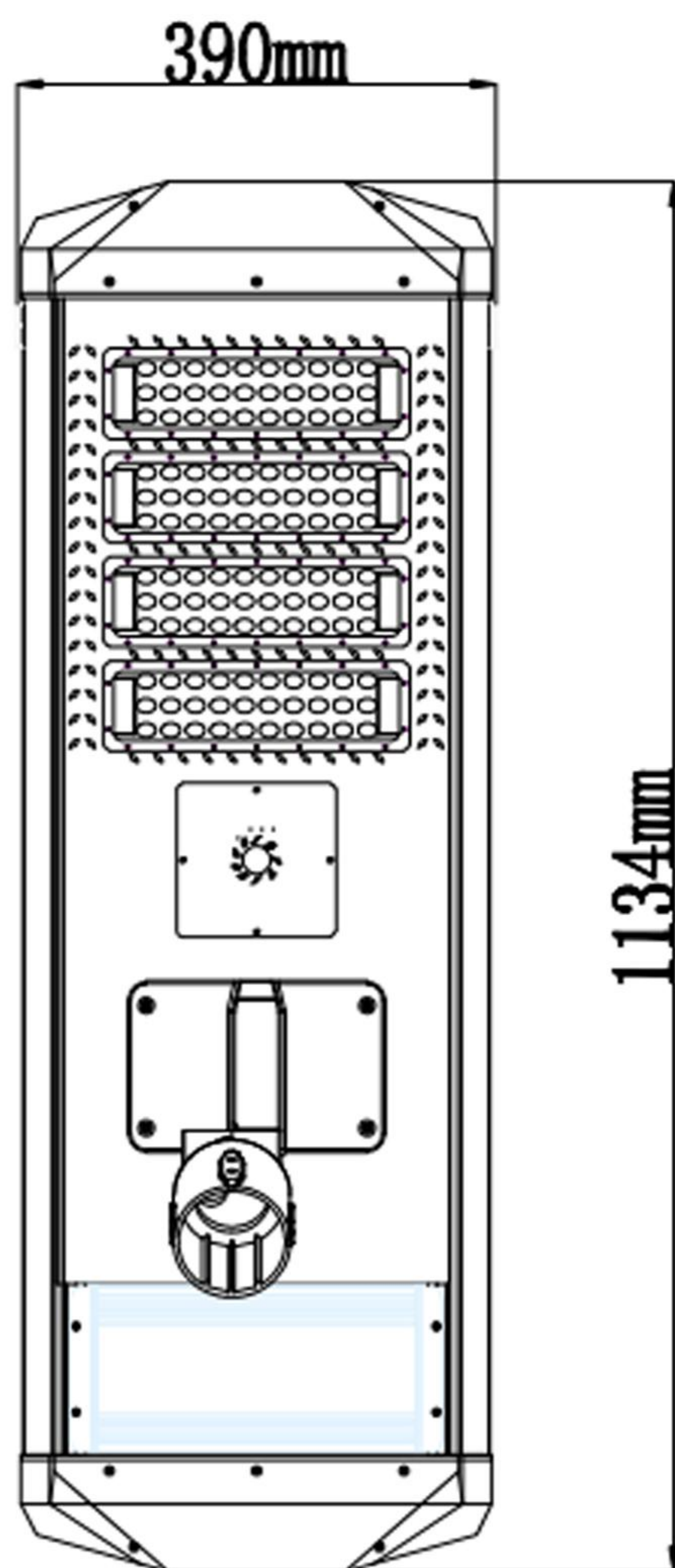
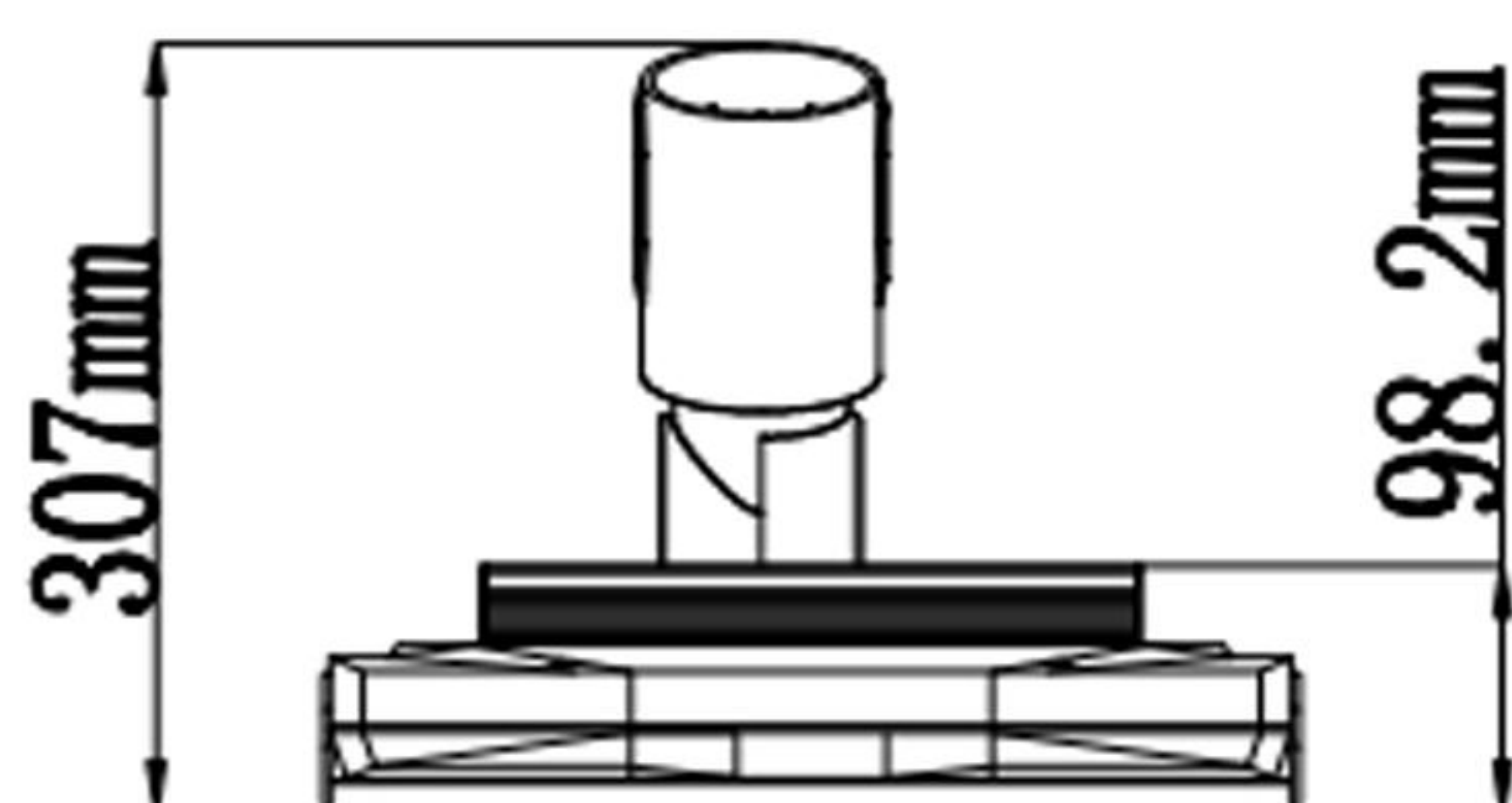



## Product parameters

Product Parameters					
Product model		AI-01	AI-02	AI-03	AI-04
Polycrystalline Solar panel		52W/16V	66W/16V	82W/16V	102W/16V
Battery		260WH	330WH	410WH	480WH
LED	Number of LEDs	30*2PCS	30*3PCS	30*4PCS	30*5PCS
	Color temperature	6000-7000K	6000-7000K	6000-7000K	6000-7000K
	System Lumens (lm)	4000	6000	8000	10000
	Life	50000H	50000H	50000H	50000H
Working mode		Integration of time control and induction, with 13 key remote control			
Charging time (H)		8	8	8	8
Discharge time (H)		10-12 hours per day, 5-7 rainy days			
Lamps material		Aluminium Alloy			
Certification		CE/IP66			
Finished product code		01.ACI.10 Lithium 01.ACI.11 Lifepo	01.ACI.20 Lithium 01.ACI.21 Lifepo	01.ACI.30 Lithium 01.ACI.31 Lifepo	01.ACI.40 Lithium 01.ACI.41 Lifepo
Product package size		Packaging of lamp body: 875*160*460mm Multifunctional base: 250*220*155mm	Packaging of lamp body: 960*160*460mm Multifunctional base: 250*220*155mm	Packaging of lamp body: 1210*160*460mm Multifunctional base: 250*220*155mm	Packaging of lamp body: 1455*160*460mm Multifunctional base: 250*220*155mm



## Installation Procedure

- 1.Choose the best position for lighting.
- 2.Open the package and check if the accessories are complete.
- 3.Use the ejector pin to open the switch before installation.

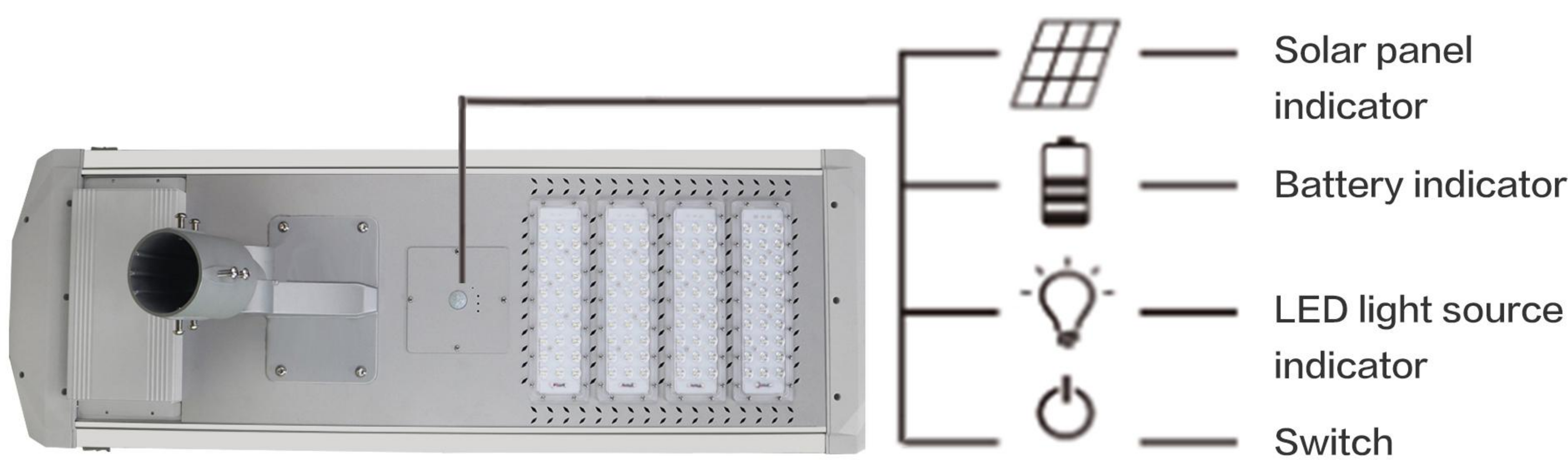

(Please note: There are three indicators on the panel)

Blue is the charging indicator:	Green is the battery indicator:	Red is the LED light source work indicator:
Slow flashing means charging, full light means fully charged, and turning off light means no charging.	Full light indicates that the battery is normal and can work normally; slow flashing indicates low battery and cannot work normally, need to charge right now.	When the LED light source is working, the red indicator light is fully illuminated. When the LED light source is not working, the red indicator light is off.



4. Firstly, fix the base to the lifting device with screws, then put the solar panel of the lamp body up, insert the lamp into the pole with the base facing down, and tighten the screws. (As figure 1)

【 Regular base 】



As figure 1

#### Note

- During installation, one or two people shall hold the lamp body, and another person shall tighten the nut, so as to avoid misplacement of the nut due to force during the tightening process, or would result in nut sticking and subsequent undisassembly.
- It is recommended to install on a sunny day, because it can't be charged quickly after installation in rainy days, and it will be discharged at night, which will affect the using effect.
- If the lamp does not work after the package is opened, it is usually because the battery power is insufficient. Charge it for 2 days before installation.



SPECTRA

See our luminaire catalog for an image of the luminaire.

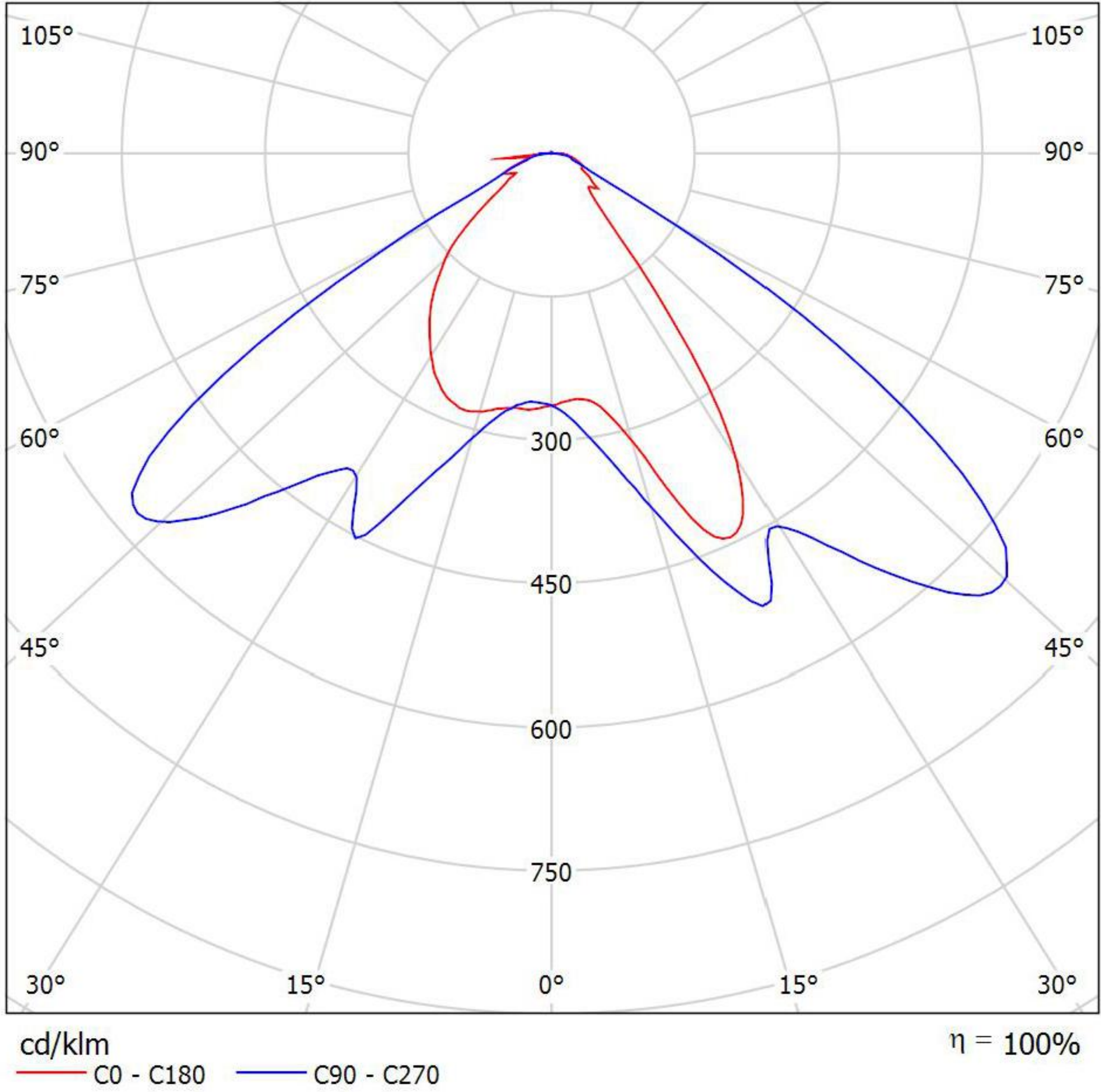

Luminaire classification according to CIE: 100  
CIE flux code: 56 90 98 100 100

Due to missing symmetry properties, no UGR table can be displayed for this luminaire.

Road lighting simulation

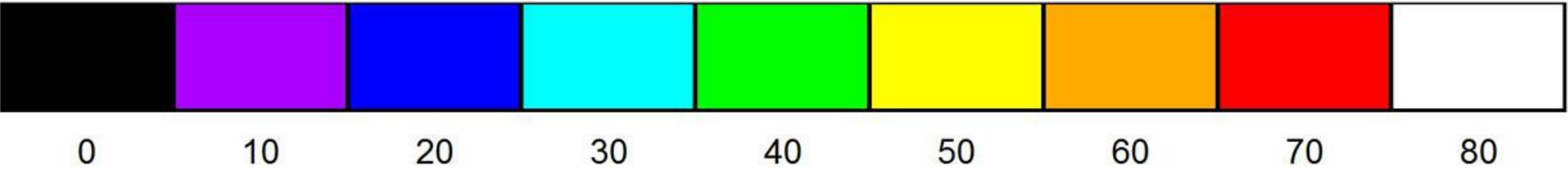
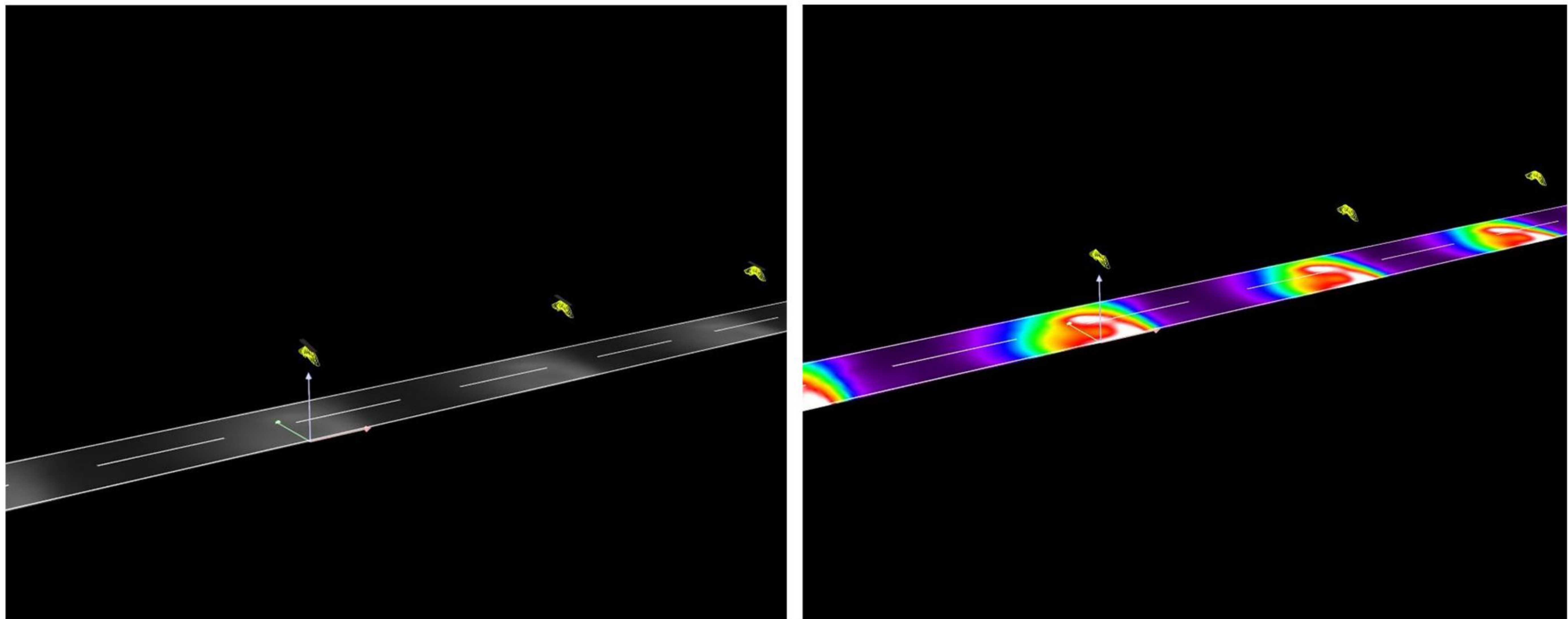



### Note 1

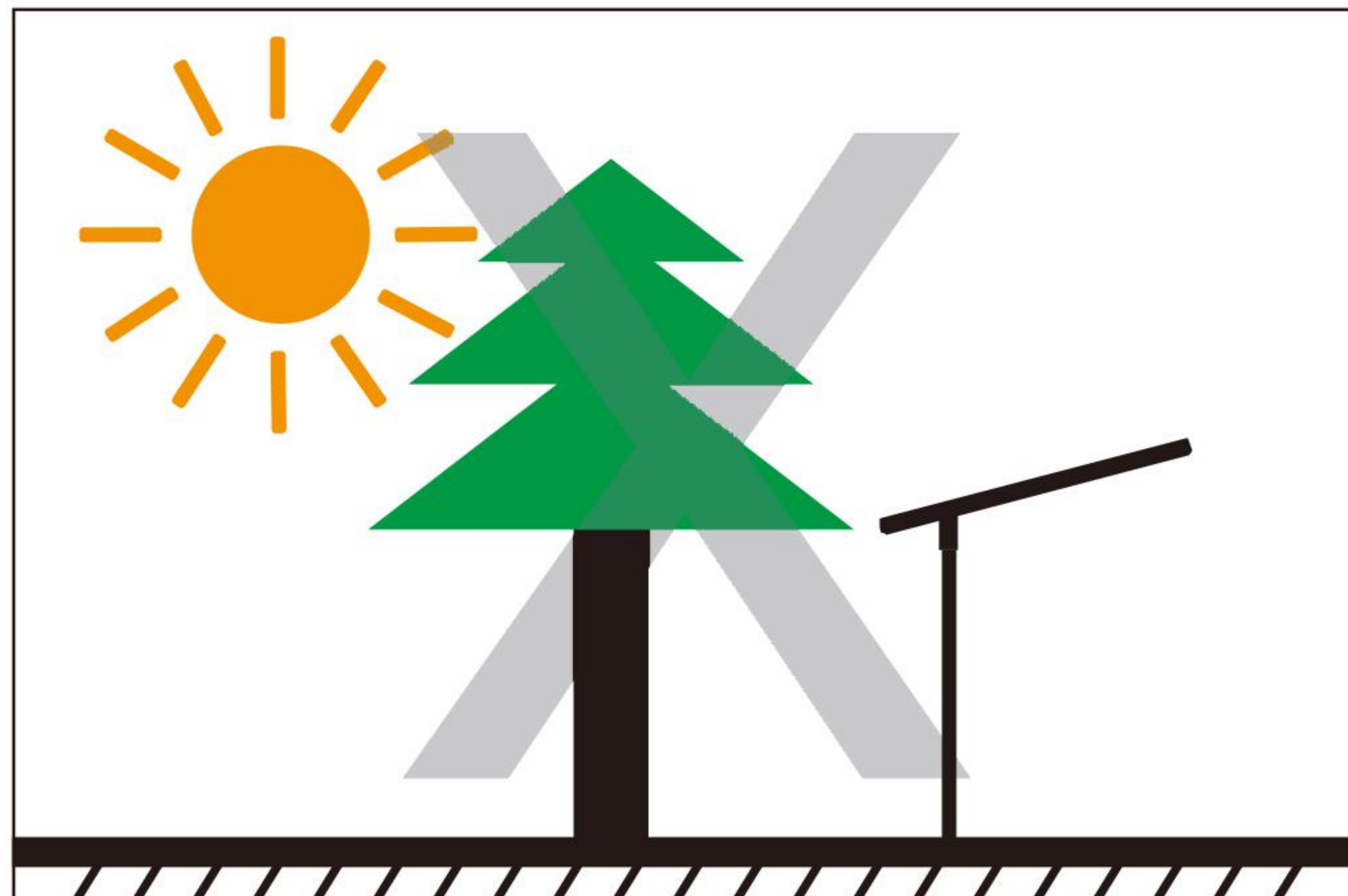
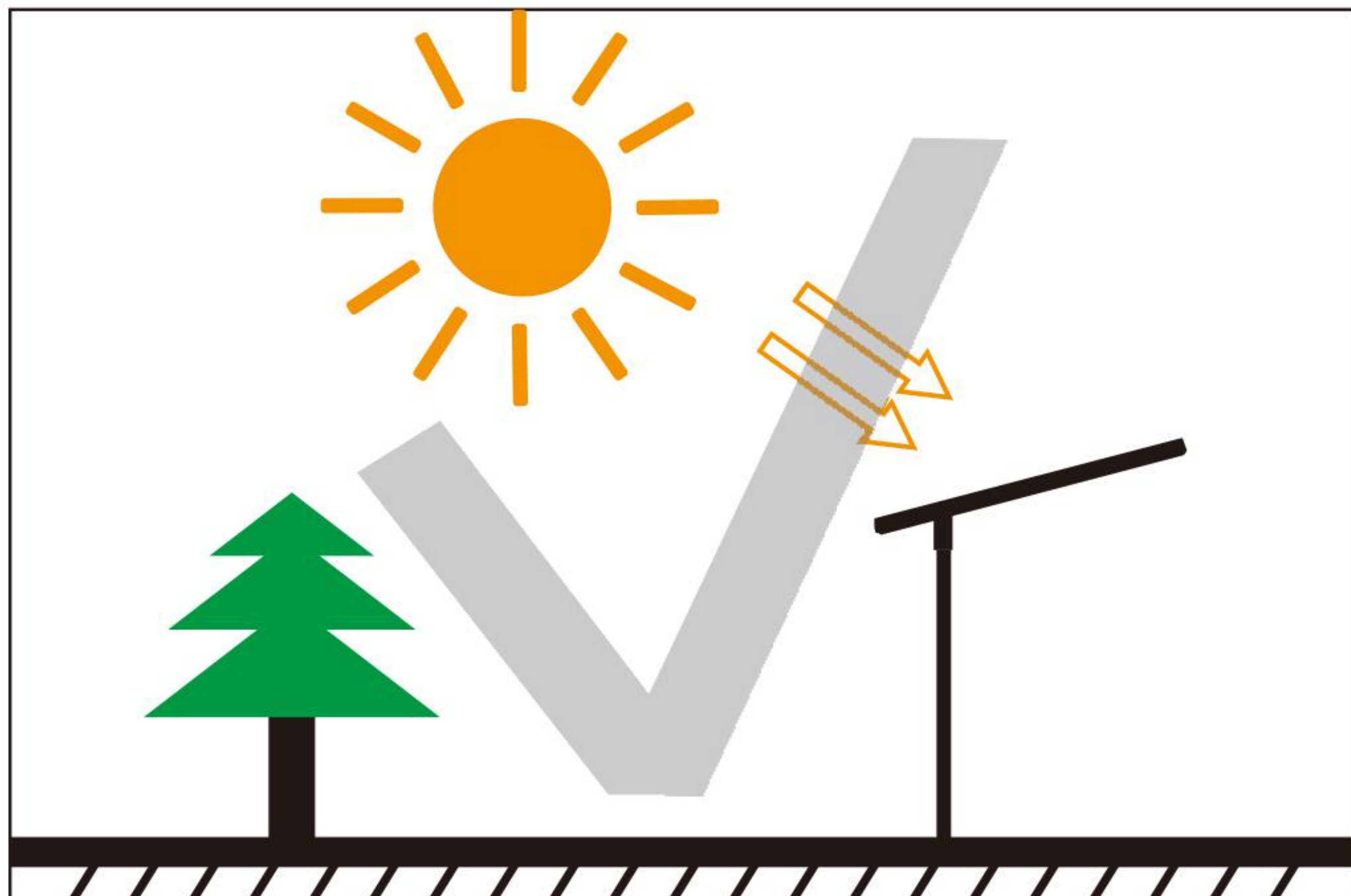

### Note 2

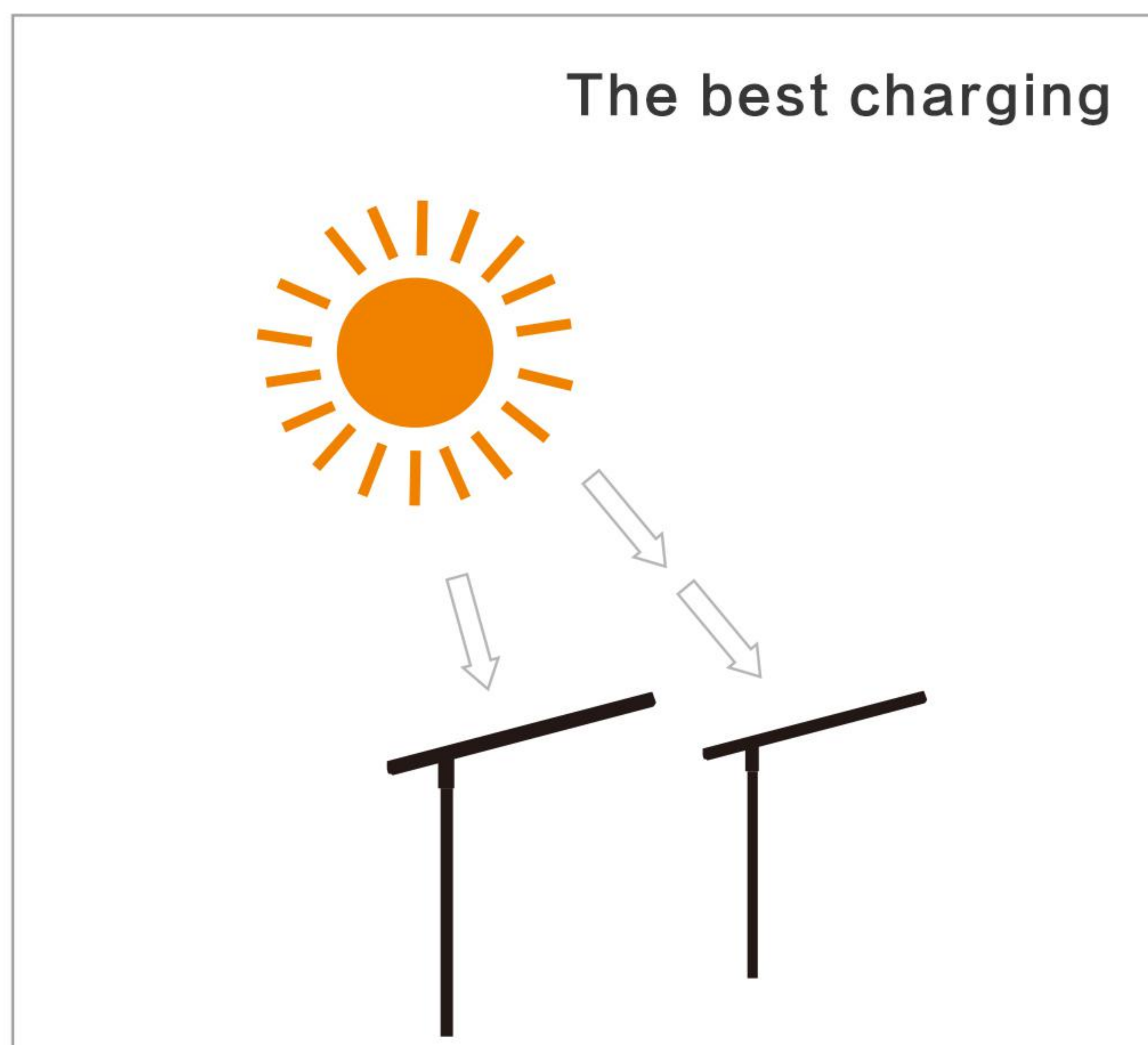
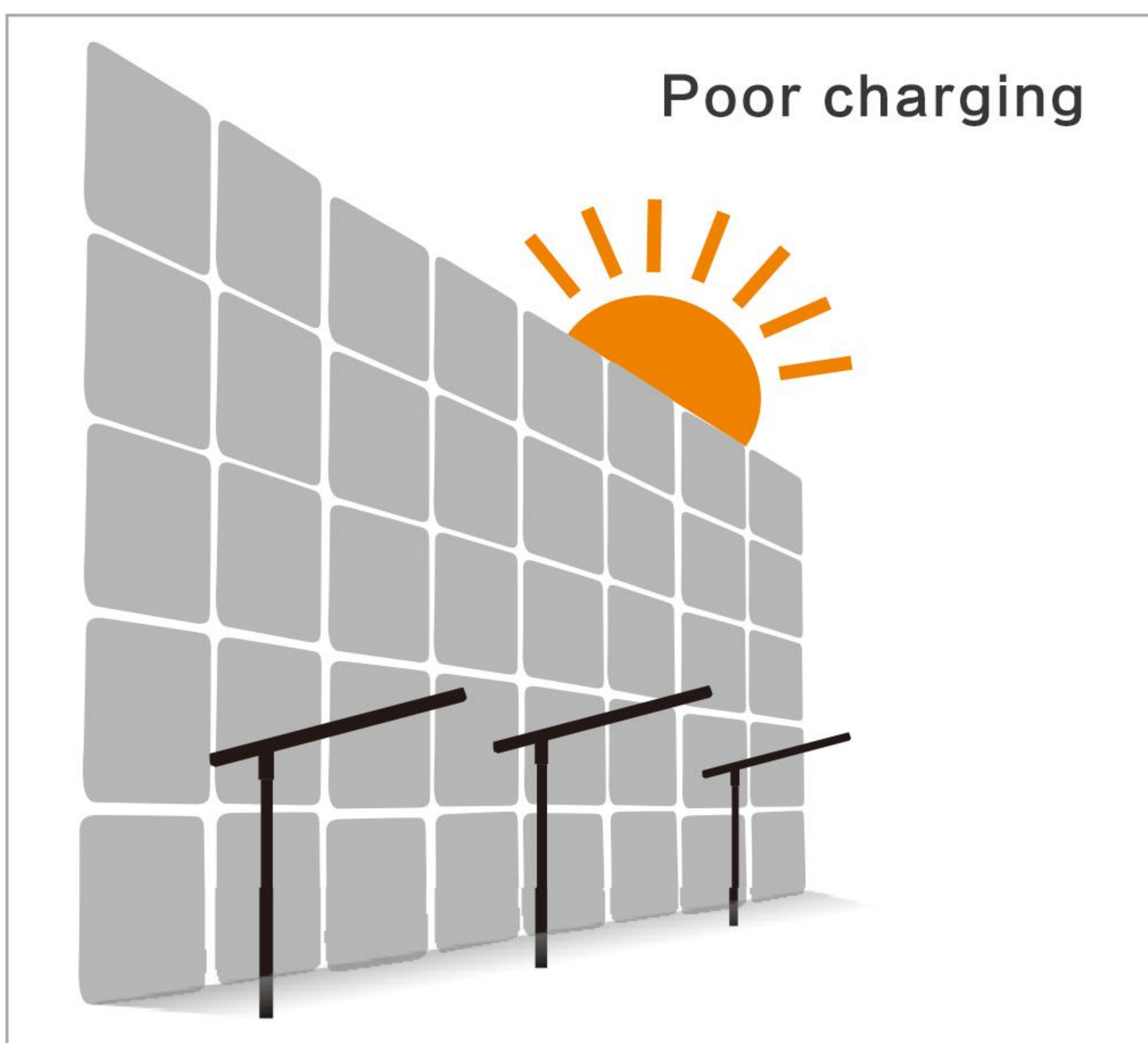

When install the integrated solar led street, please choose a position with enough sunshine and fully exposure.  
Pls note the panel must be fully exposed, without any shelter.